



***EVOI***

# INTRODUCTION

Dear customer, thank you for purchasing our MECA EVO1 pedal set.  
Our pedal set is designed to ensure an increasingly realistic driving experience.

The pedal set contains the standard adjustable base for installation on simulation platforms. Before you install or use the product, please read the manual which will provide the basic information required for the first installation, the possible configuration of the pedal set.

For any further information, please visit the "Support" section on our website.

# TABLE OF CONTENTS

04	Contents of packaging
05	Pedal set assembly
11	Mechanical adjustments

CONTENTS OF PACKAGING

Baseplate

- 1x Baseplate with heel plate
- 4x M8x30 screw
- 4x M6x12 screw
- 4x M8 nut
- 8x Steel washer
- 4x Plastic washer

Throttle pedal

- 1x Throttle pedal
- 4x T-Nut
- 4x M6x18 screw
- 4x Steel washer
- 4x Plastic washer
- + Accesories

Hydraulic Brake pedal

- 1x Hydraulic brake pedal
- 1x Hydraulic pressure transducer cable
- 6x M6 T-Nut
- 4x M6x18

- 4x Steel washer
- 4x Plastic washer

Load-cell Brake pedal

- 1x Load-cell brake pedal
- 4x M6 T-Nut
- 4x M6x18 screw
- 4x Steel washer
- 4x Plastic washer
- 1x Set polyurethane bushings (2x Black, 2x Blue, 2x Orange)

Clutch pedal

- 1x Clutch brake pedal
- 4x T-Nut
- 4x M6x18 screw
- 4x Steel washer
- 4x Plastic washer

Accesories

- 1x Electronic box
- 2x M6 T-Nut
- 1x USB-C cable
- 1x Product manual with QR code
- 1x Long throttle face-plate\*

\* optional accesory to be bought separately

PEDAL SET ASSEMBLY

I) BASEPLATE PRE-ASSEMBLY

Place T-Nuts on designated positions into the baseplate

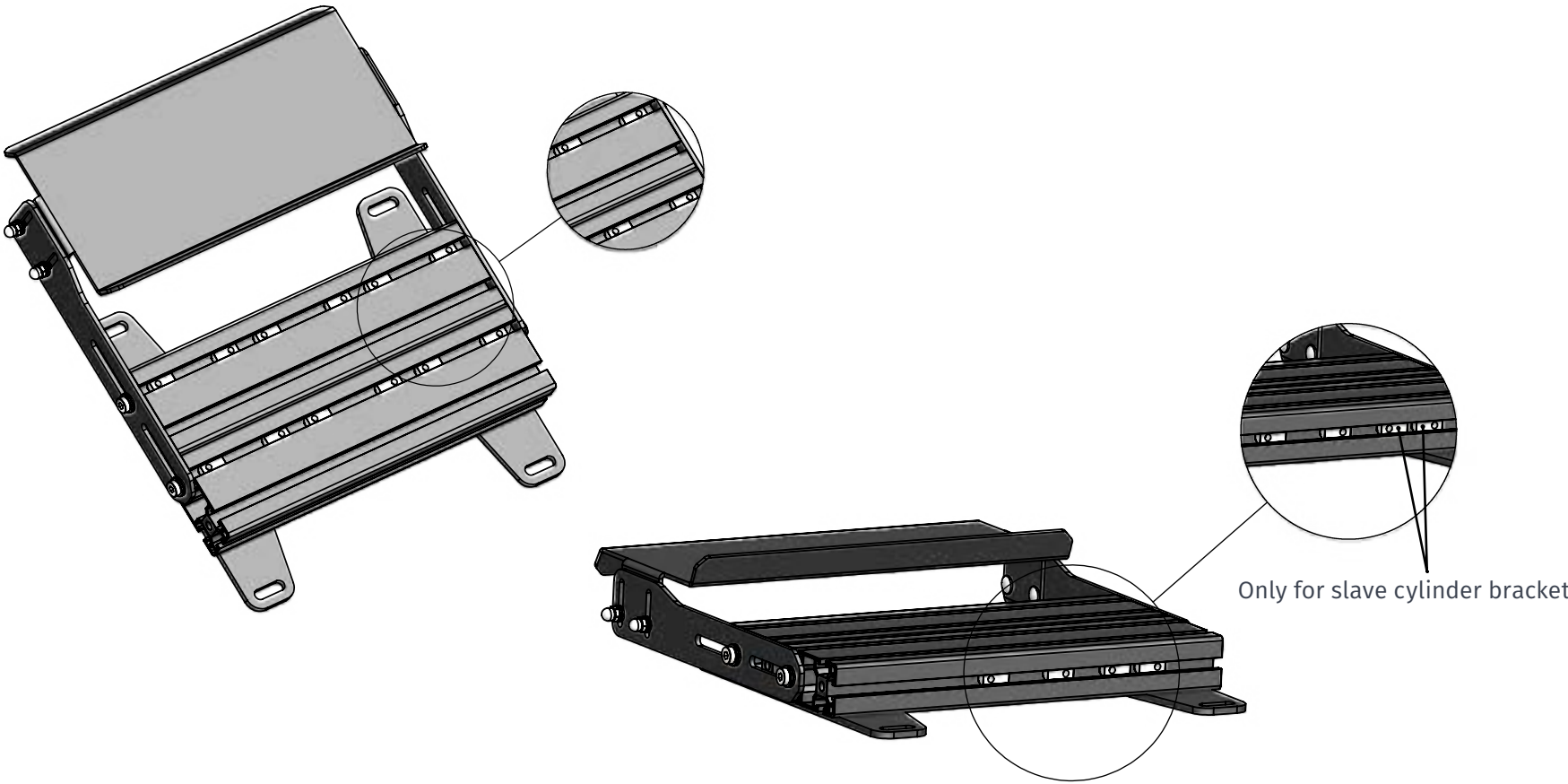

**2) MOUNT BRAKE PEDAL AND ELECTRONICS BOX ASSEMBLY**

Mount the brake pedal, slave cylinder\* and electronic box assembly onto the baseplate

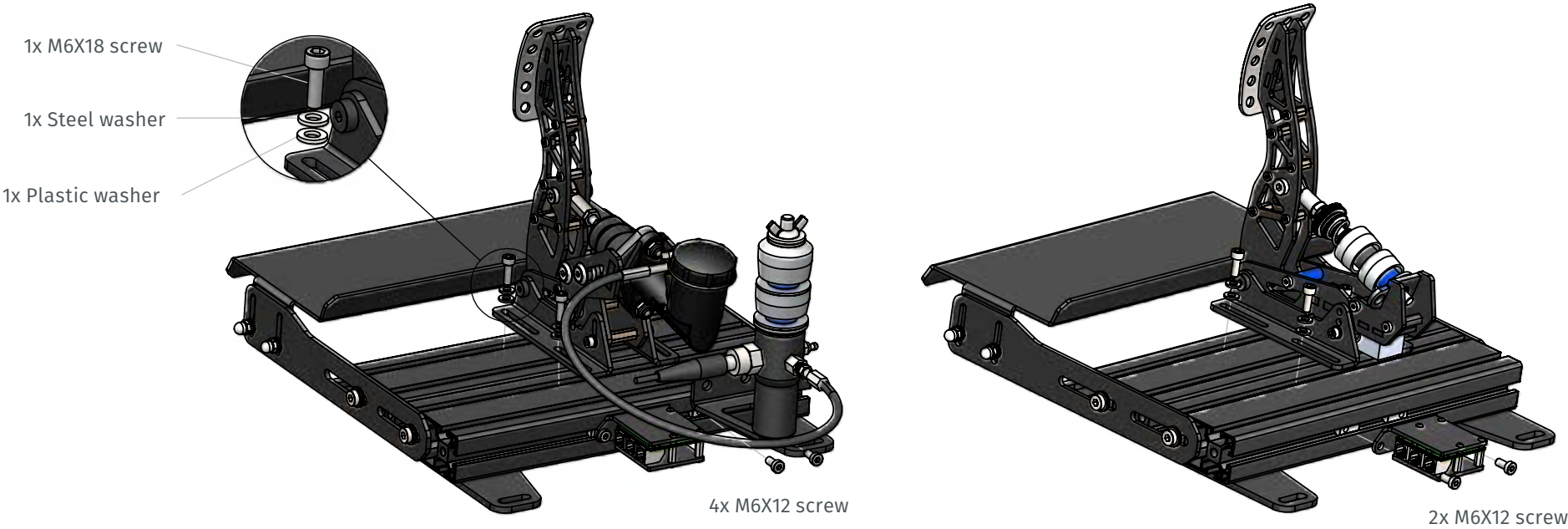

\*only for hydraulic brake pedal option

**3) MOUNT CLUTCH & THROTTLE PEDALS**

Mount clutch and throttle pedal onto the baseplate

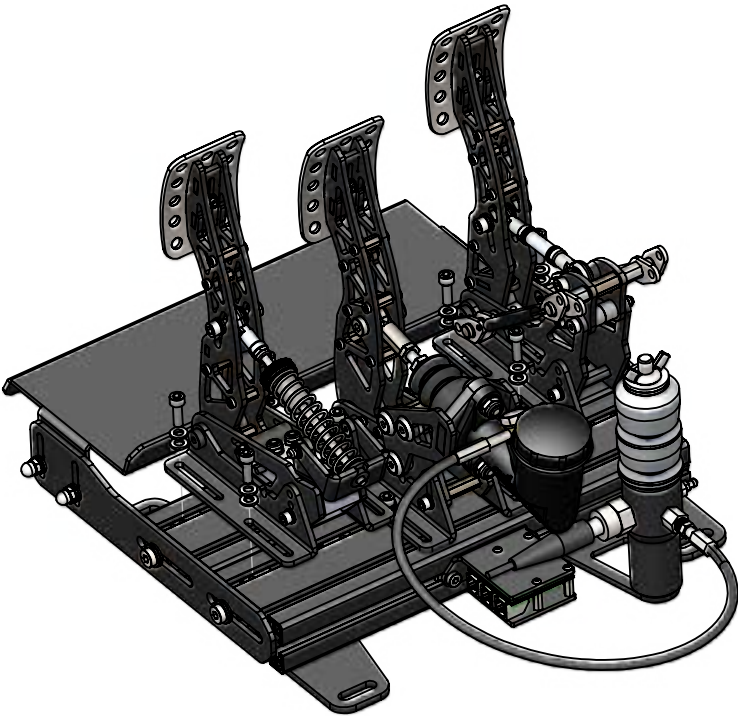

4) **CONNECT PEDALS INTO THE ELECTRONICS BOX**

Connect RJ11 pedal cables into it's designated slots

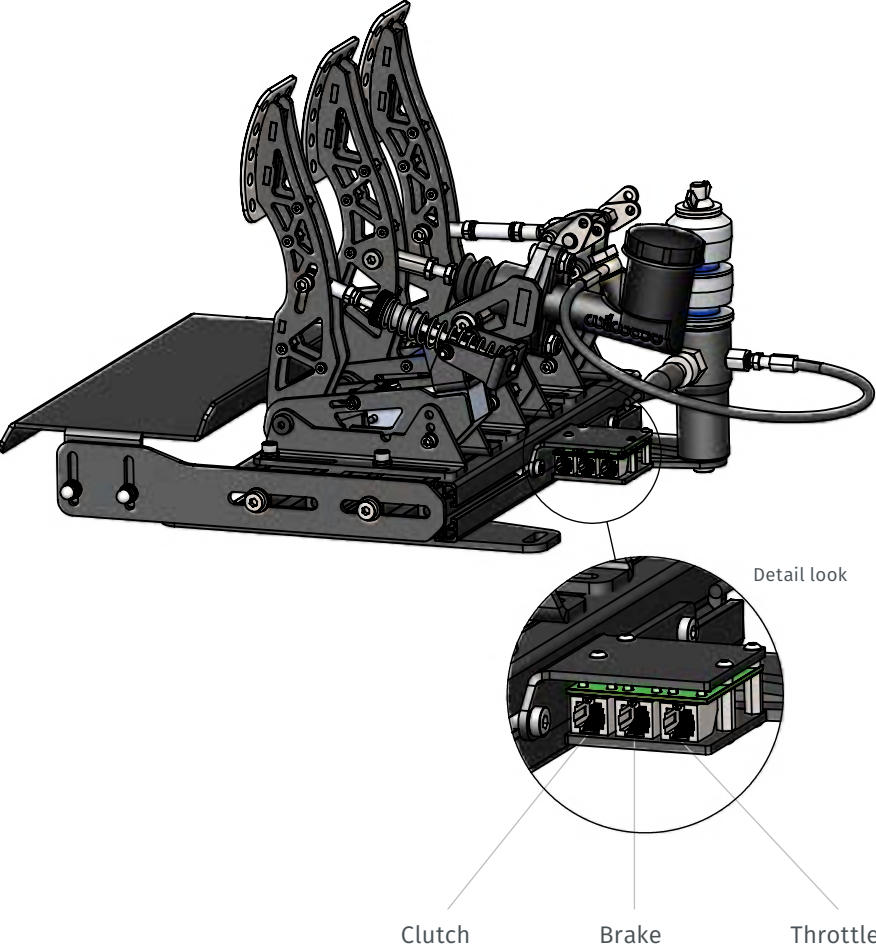

5) **MOUNT PEDAL SET ASSEMBLY ONTO THE RIG**

1) Loosen the heel plate and put it into the forward position to make place for the mounting holes

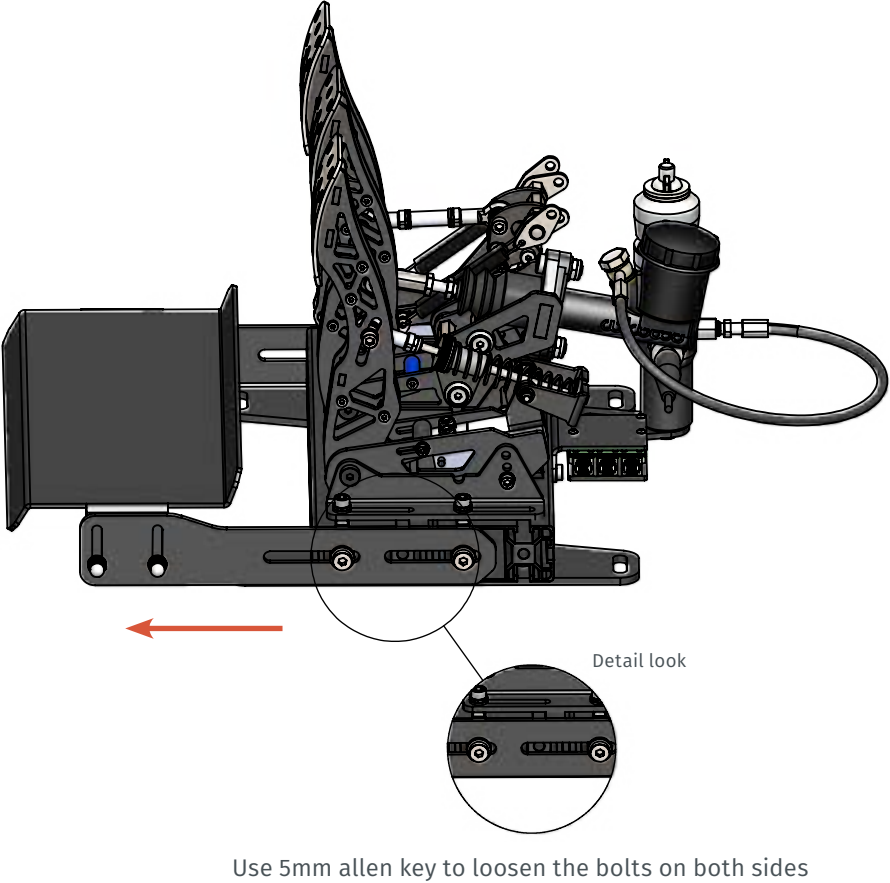

2) Mount **baseplate** to the rig



## MECHANICAL ADJUSTMENTS

### BASEPLATE ADJUSTMENTS

For baseplate adjustments, you will need 5mm and 4mm allen key and 10mm socket key

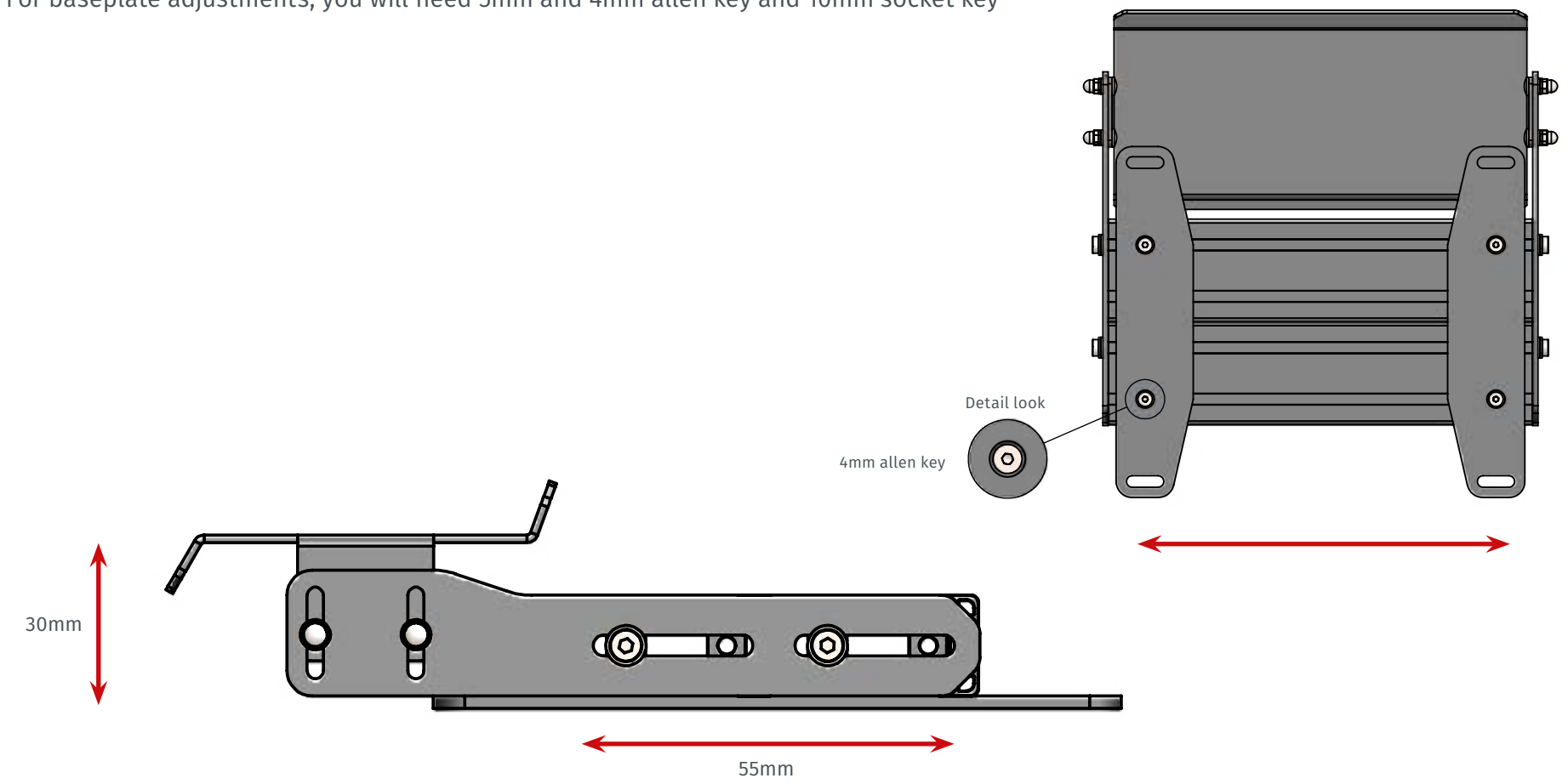



**THROTTLE PEDAL ADJUSTMENTS**

For throttle pedal adjustments, you will need 5mm and 4mm allen key and 10mm socket

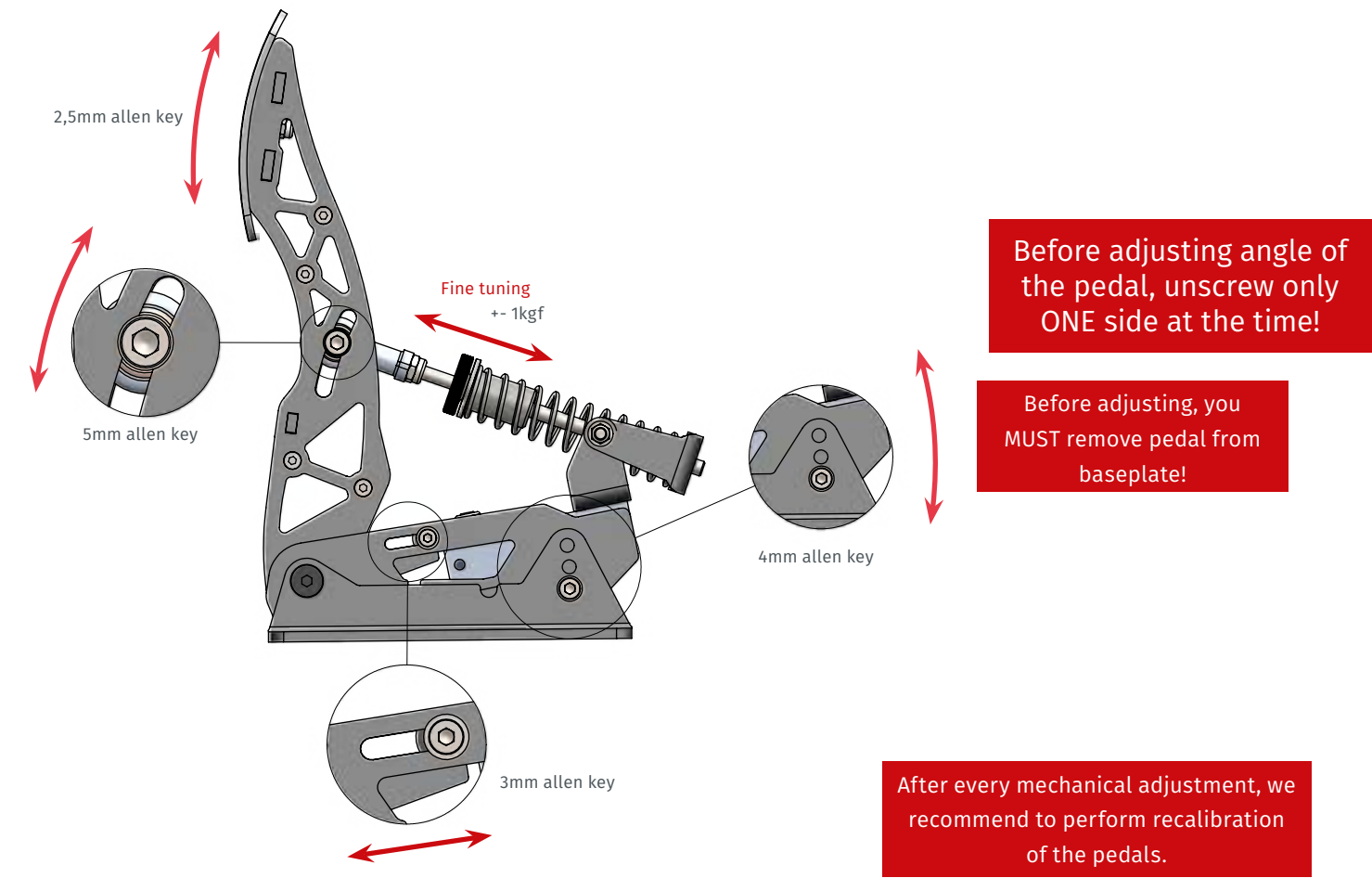

To change the faceplate, you have to loosen the spring preload on spring assembly and remove the rod from it's housing

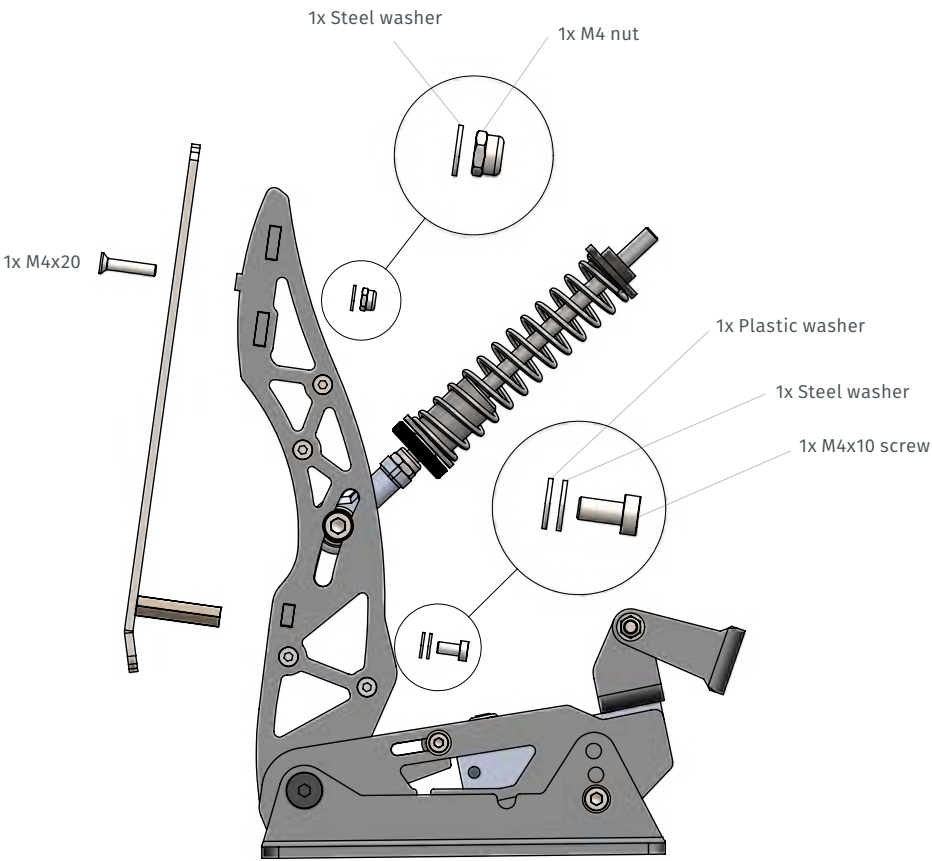

**Brake Pedal (Hydraulic) Adjustments**

For brake pedal adjustments, you will need 4mm allen key and 13mm key

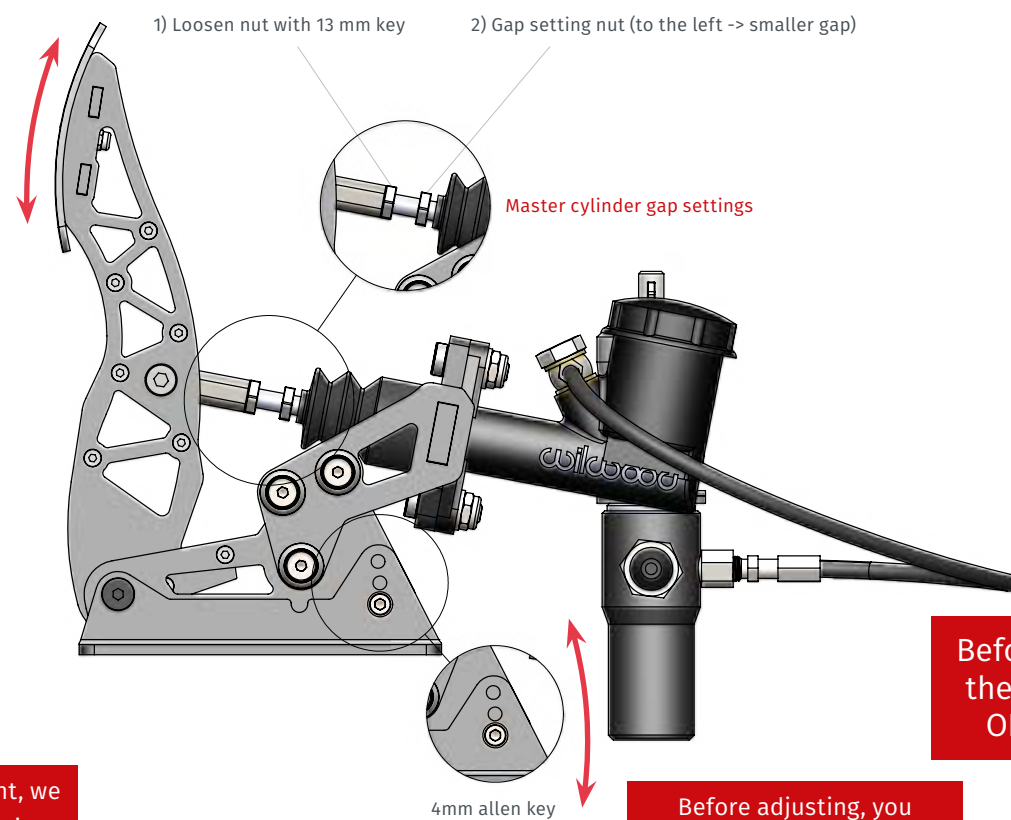

After every mechanical adjustment, we recommend to perform recalibration of the pedals.

Before adjusting, you MUST remove pedal from baseplate!

Before adjusting angle of the pedal, unscrew only ONE side at the time!

**Slave Cylinder Adjustments**

You can adjust the hydraulic brake travel using the butterfly nut

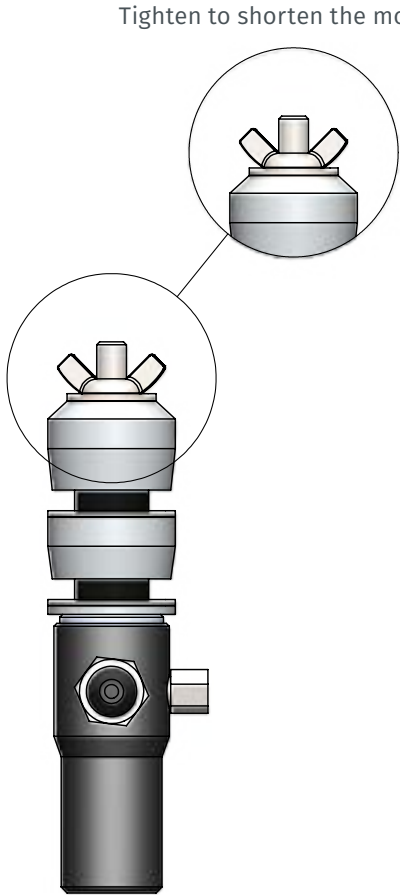

After every mechanical adjustment, we recommend to perform recalibration of the pedals.

Slave cylinder with only one polyurethane for shorter travel

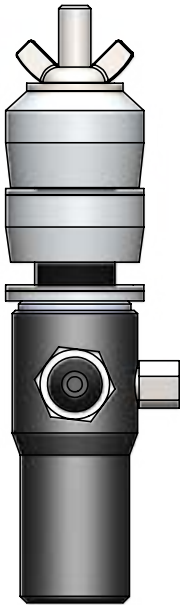

**POLYURETHANE BUSHINGS**

Combination		Firmness level
Black	Black	1
Black	Blue	2
Blue	Blue	3
Black	Orange	4
Blue	Orange	5

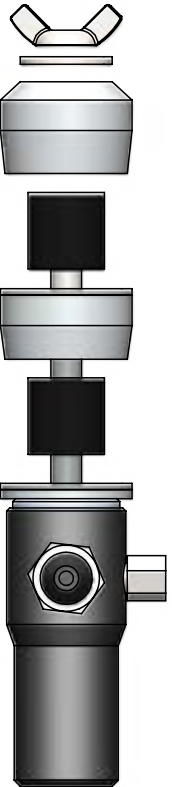



**BRAKE PEDAL (LC) ADJUSTMENTS**

For brake pedal adjustments, you will need 4mm allen key and 13mm key

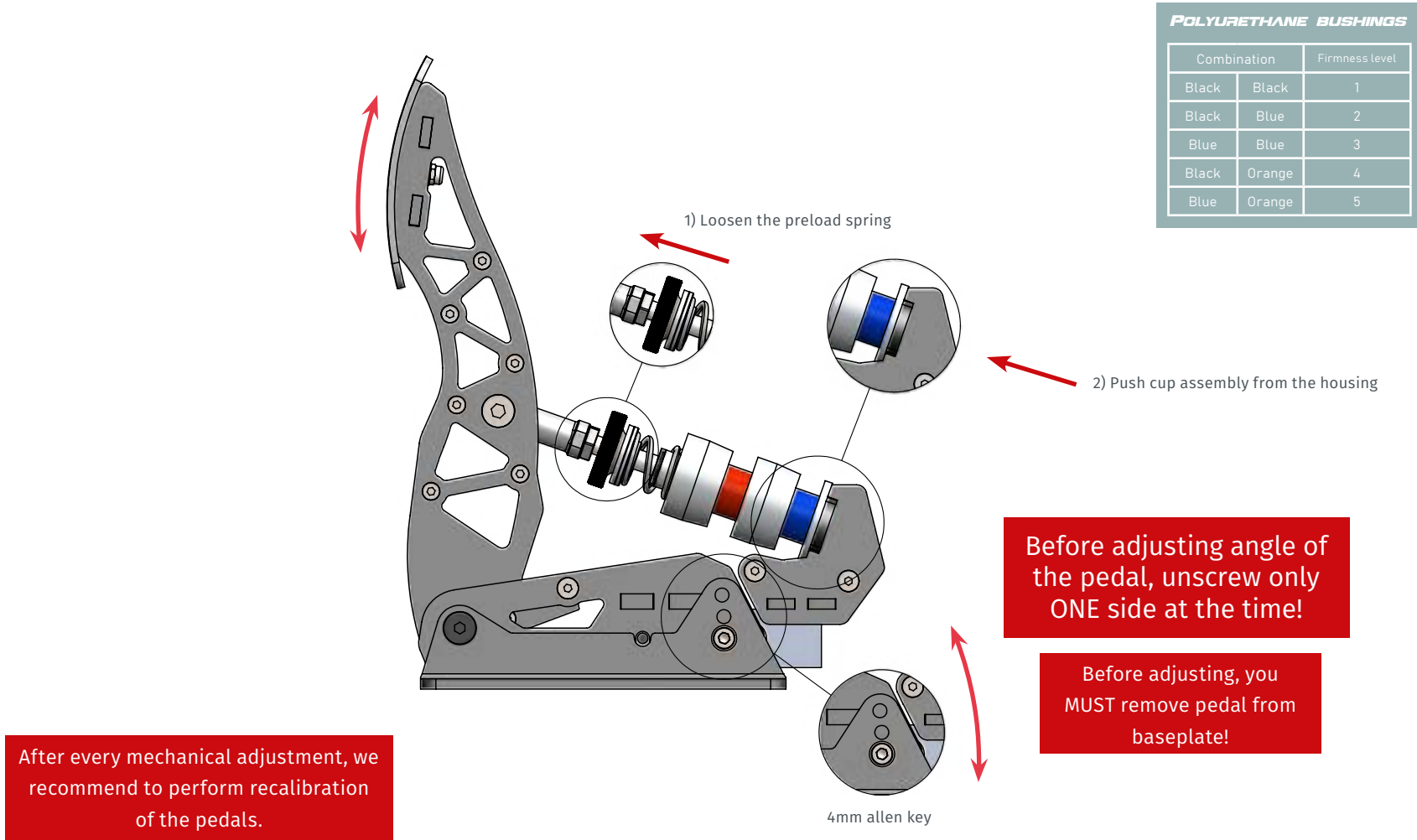

**BRAKE PEDAL (LC) MAINTENANCE**

To ensure proper operation of load-cell brake pedal, it's recommended to lubricate leading rod every 100 hours

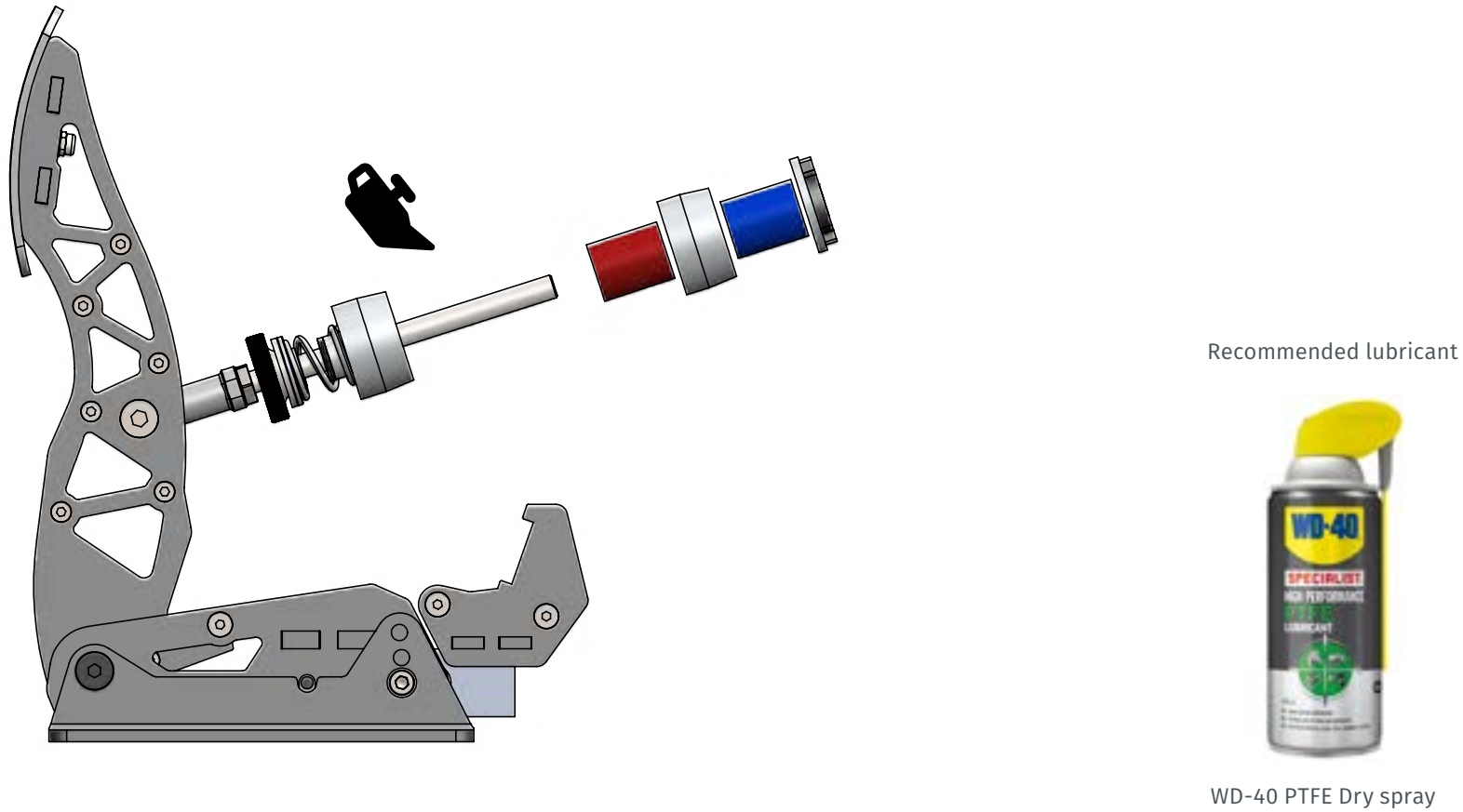

**CLUTCH PEDAL ADJUSTMENTS**

For clutch pedal adjustments, you will need 5mm and 4mm allen key and 10mm socket key

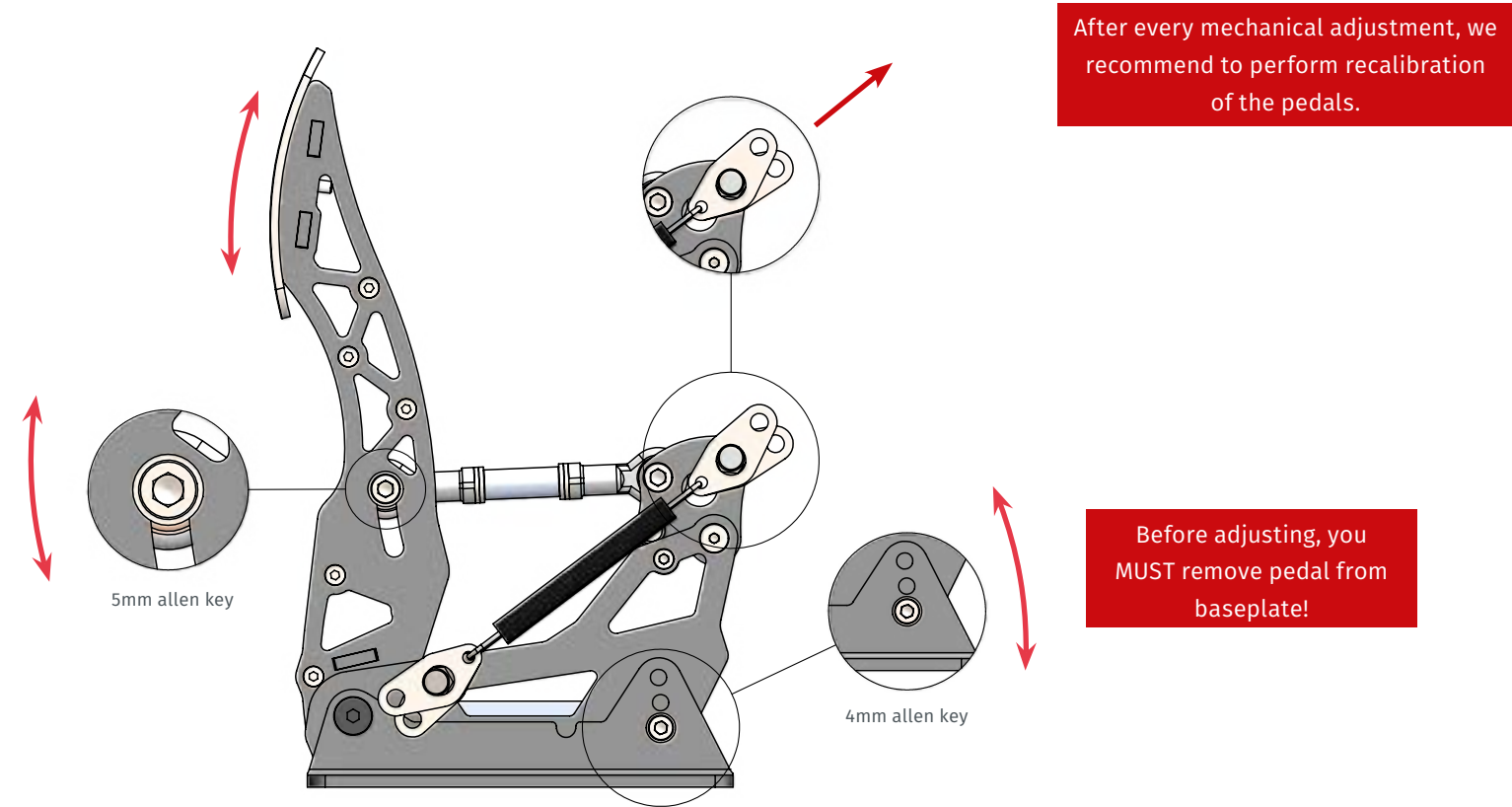

**CONTACT**

Email: [support@mecasimhardware.com](mailto:support@mecasimhardware.com)  
Website: [www.mecasimhardware.com](http://www.mecasimhardware.com)